

Assembly Instruction

Breanne 3pce Outdoor set

(Single chair)

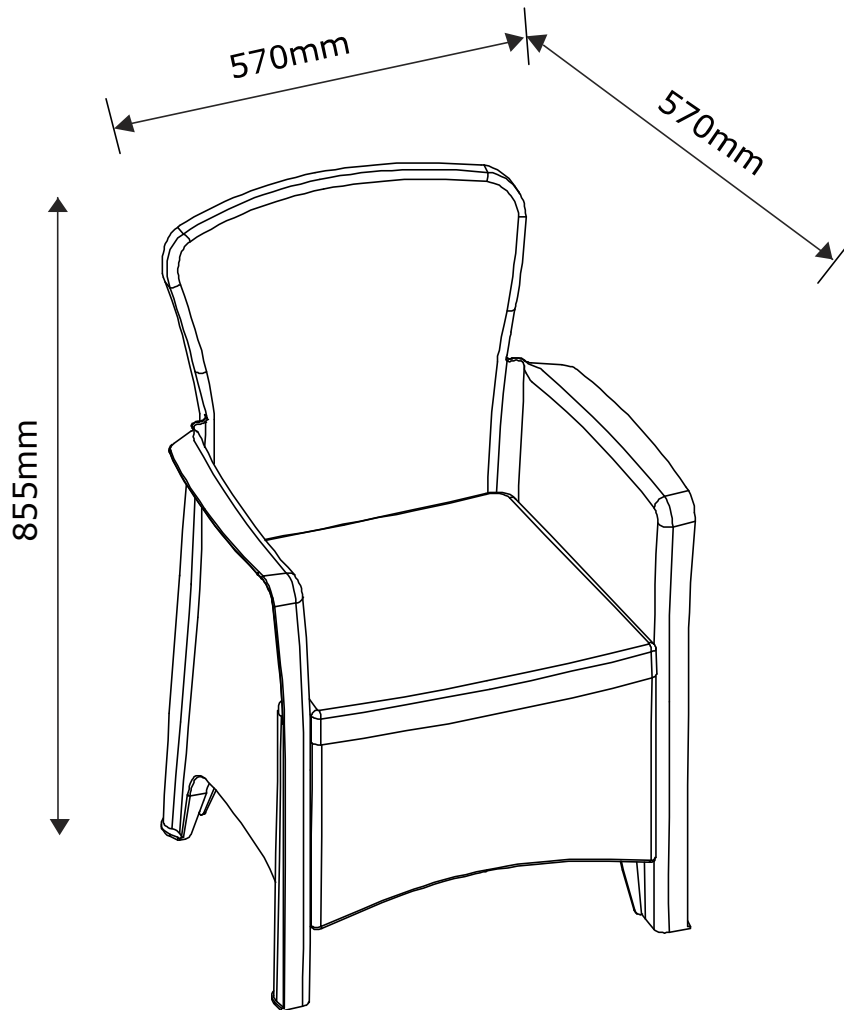

Please read the Assembly Instructions carefully
before assembling.

Imported By PRODESIGN FURNITURE PTY LTD.

WARNING

**FAILURE TO FOLLOW THESE BASIC STEPS CAN LEAD TO
DAMAGE THAT IS NOT COVERED BY YOUR WARRANTY**

1. Read instructions carefully. Check no parts are missing.
2. Lay out all of the components on a soft surface as if you were preparing to do a jigsaw puzzle.
3. Carefully identify each component, especially those that are similar. The most common mistake is getting things back to front.
4. Separate and identify each component from the hardware pack and rest each one in its proper location before fastening.
5. **DO NOT** fully tighten screws (leave slightly loose). When the item is fully assembled tighten the screws - but do not over tighten.
6. Always lift the chair to move. Do not drag the chair.

What you need

to assemble the product

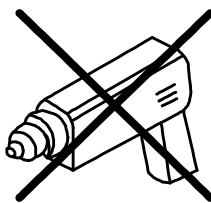

DO NOT USE ON PRODUCT

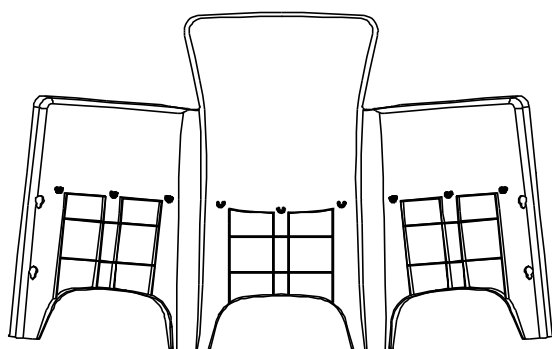

①

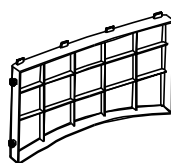

②

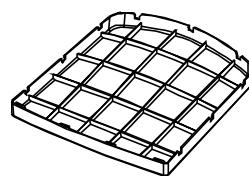

③

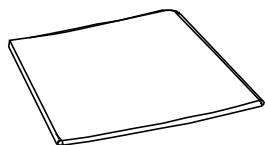

④

NO.	PARTS LIST	QTY
(1)	CHAIR FRAME	1
(2)	FRONT	1
(3)	SEAT	1
(4)	SEAT CUSHION	1

Please make sure you have all these parts before you start.

Step 1

Two people are needed here.

Fold the sides of Chair Frame (1) towards each other as shown.

Hook Front (2) onto the right side as shown.

Press Front (2) gently downwards until you hear the parts click together.

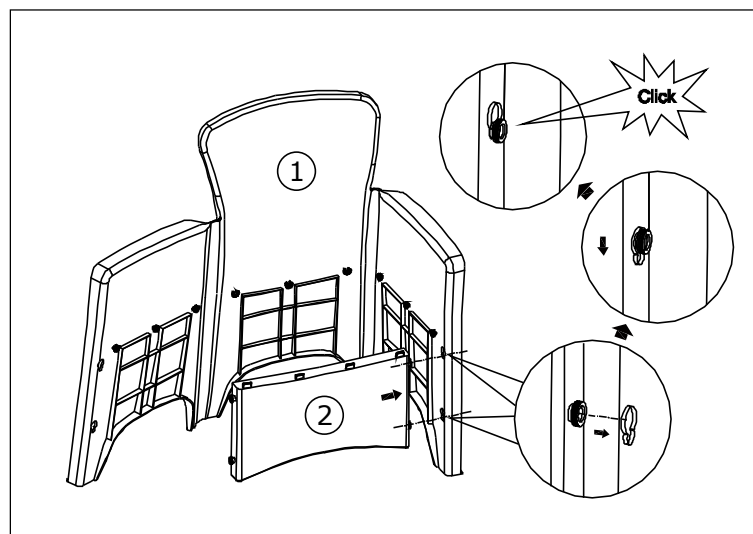
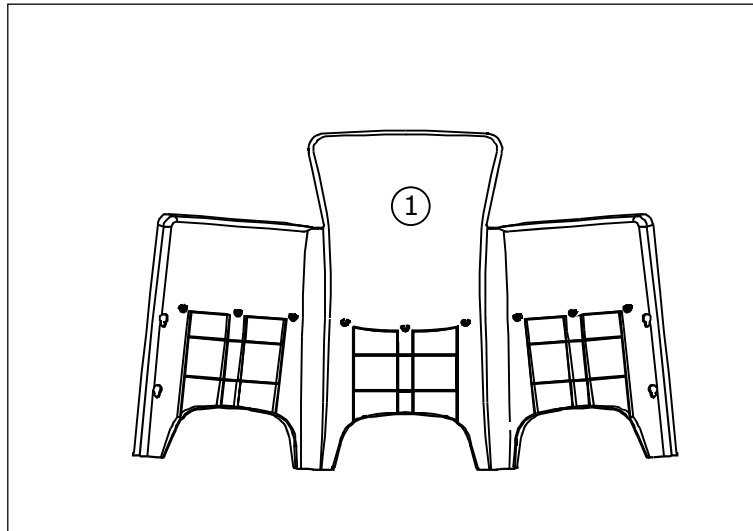

Step 2

Fold the left side of Chair Frame (1) towards Front (2).

Hook Front (2) onto the left side of Chair Frame (1).

Press gently until you hear the parts click together.

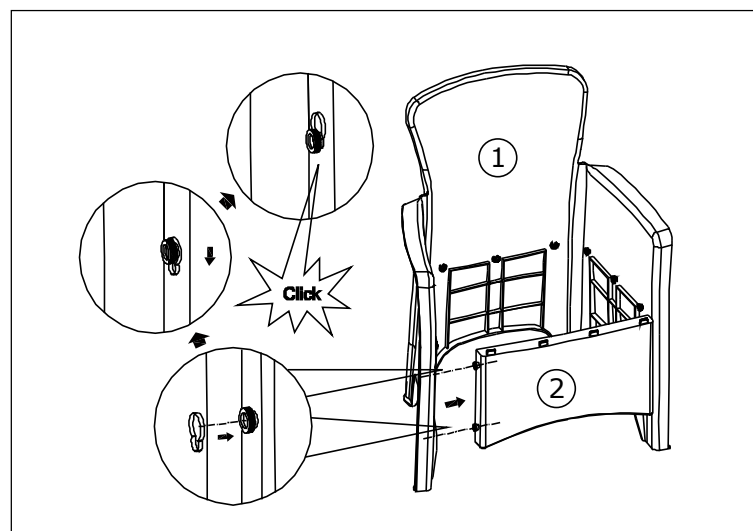

Step 3

Position Seat (3) onto the unit.

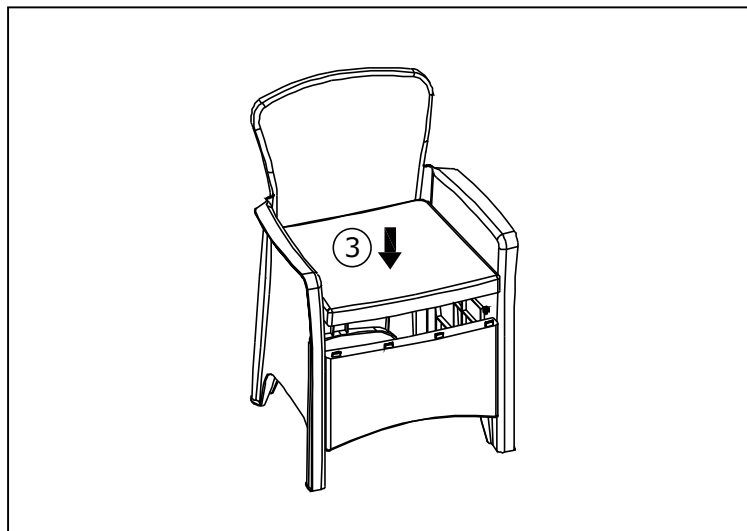

Step 4

Firmly press Seat (3) onto the unit until you hear the parts click together.

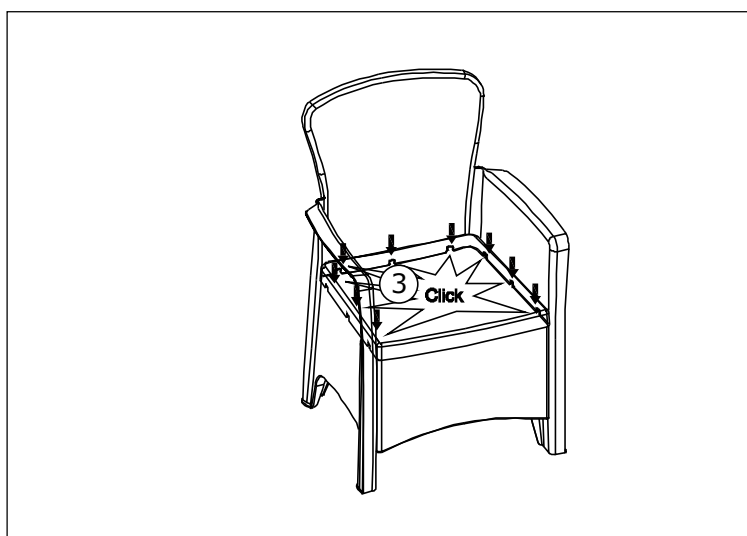

Step 5

Place Seat Cushion (4) on Seat (3).

Repeat with the remaining chair.

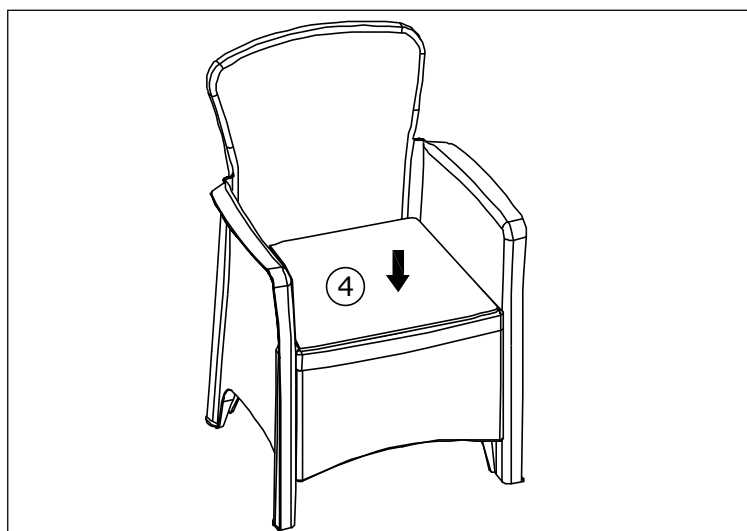

Step 6



Job Complete !

In the interest of our environment Please dispose of all packaging thoughtfully.

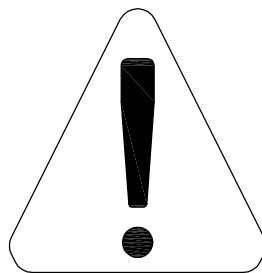

For light daily cleaning, use a clean, damp cloth (not wet).
In case stronger cleaning is required, use only detergent specially recommended for your furniture.

CAUTION: FREQUENT EXPOSURE TO DIRECT SUNLIGHT OR SIMILAR SOURCES MAY CAUSE THE SURFACE TO DISCOLOUR OR FADE.

Always cover your furniture when not in use.

Assembly Instruction Breanne 3pce Outdoor set (Table)

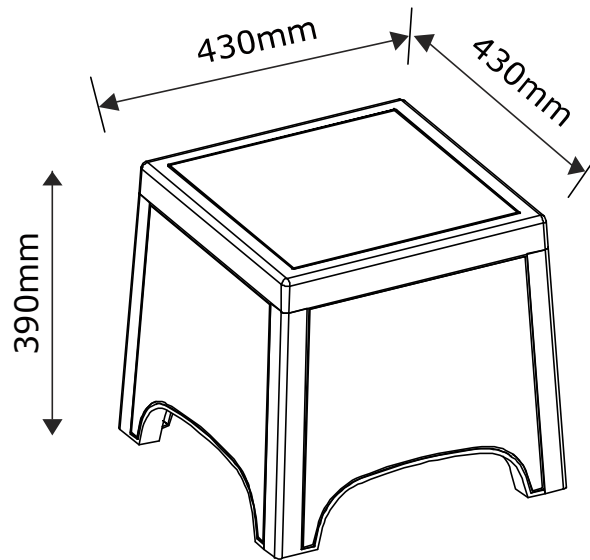

Please read the Assembly Instructions carefully
before assembling.

Imported By PRODESIGN FURNITURE PTY LTD.

WARNING

**FAILURE TO FOLLOW THESE BASIC STEPS CAN LEAD TO
DAMAGE THAT IS NOT COVERED BY YOUR WARRANTY**

1. Read instructions carefully. Check no parts are missing.
2. Lay out all of the components on a soft surface as if you were preparing to do a jigsaw puzzle.
3. Carefully identify each component, especially those that are similar. The most common mistake is getting things back to front.
4. Separate and identify each component from the hardware pack and rest each one in its proper location before fastening.
5. **DO NOT** fully tighten screws (leave slightly loose). When the item is fully assembled tighten the screws - but do not over tighten.
6. Always lift the table to move. Do not drag the chair.

What you need

to assemble the product

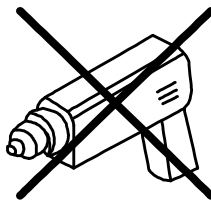

DO NOT USE ON PRODUCT

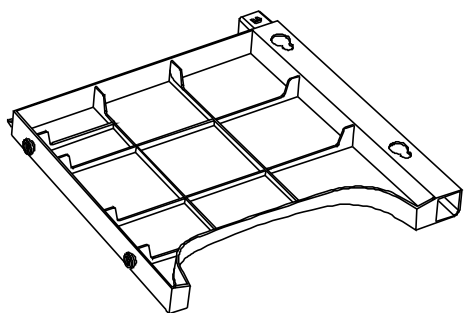

⑤

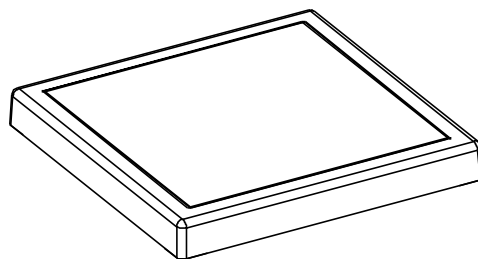

⑥

NO.	PARTS LIST	QTY
(5)	SIDES	4
(6)	TABLE TOP	1

Please make sure you have all these parts before you start.

Step 1

Hook one Side (5) onto another Side (5) as shown.

Press gently downwards until you should hear the parts click together.

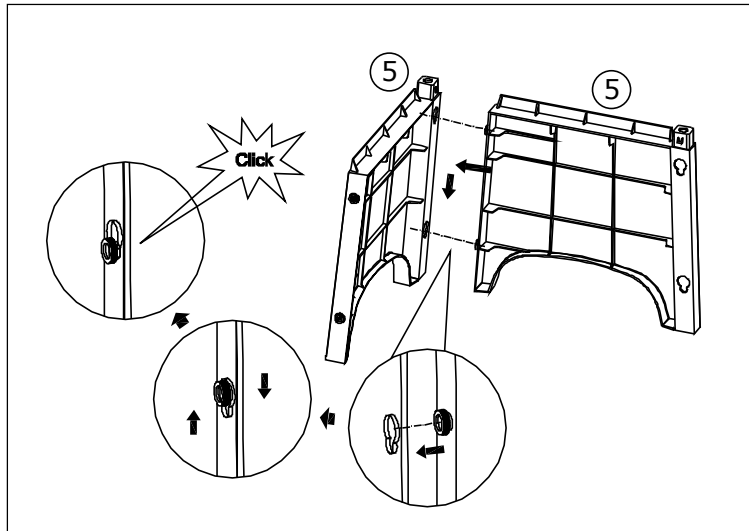

Step 2

Hook another Side (5) onto the assembled unit as shown.

Press gently downwards until you should hear the parts click together.

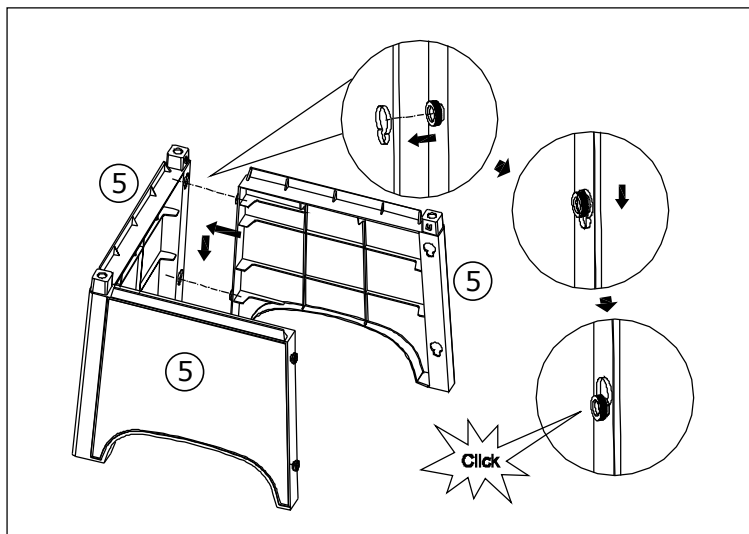

Step 3

Hook one edge of the remaining Side (5) onto one assembled Side (5).

Press gently downwards until you should hear the parts click together.

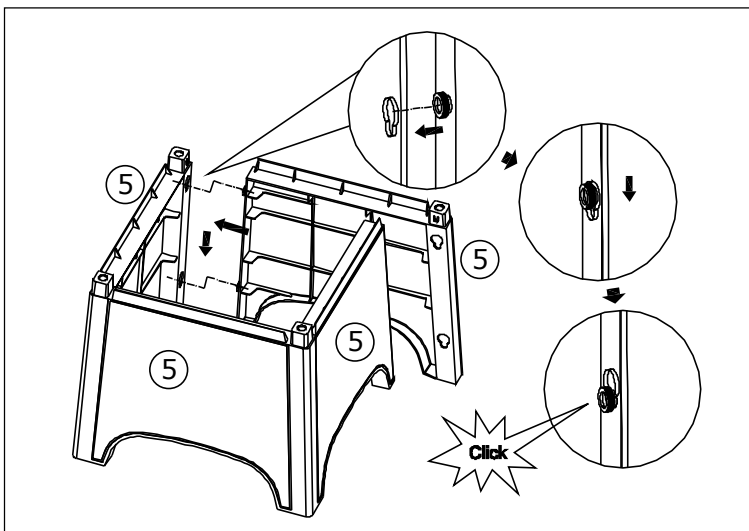

Step 4

Gently adjust and hook the remaining free edges of Sides (5) together.

Press gently downwards until you should hear the parts click together.

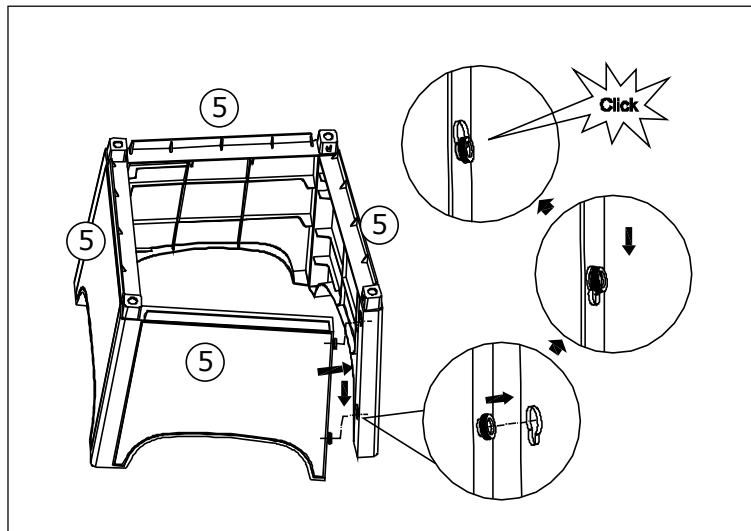

Step 5

Position Table Top (6) onto the unit.

Firmly press Table Top (6) onto the unit until you hear the parts click together.

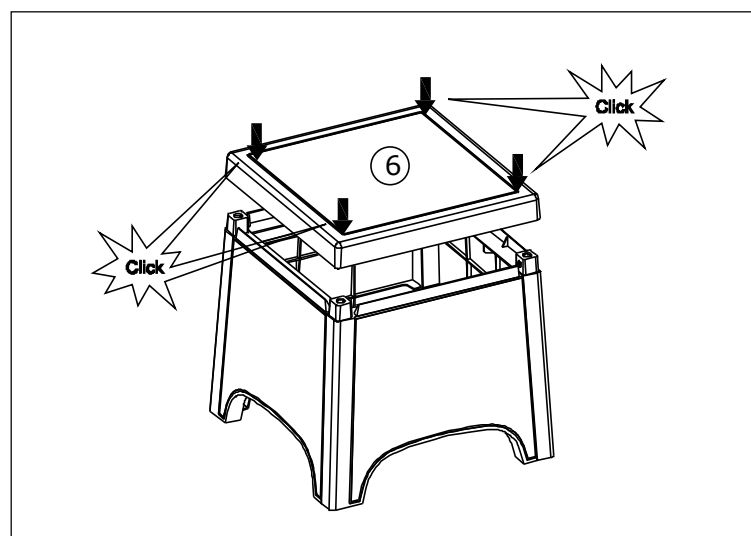

Step 6



Job Complete !

In the interest of our environment Please dispose of all packaging thoughtfully.

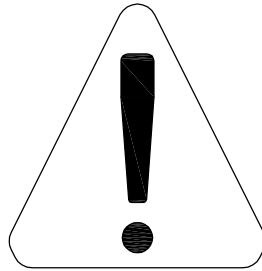

Avoid excessive wear and tear on your upholstery.
Do not allow children to jump up and down on the upholstery.
Avoid allowing pets on the upholstery as their claws may cause damage to the cover.

For light daily cleaning, use a clean, damp cloth (not wet).
In case stronger cleaning is required, use only detergent specially recommended for your furniture.

CAUTION: FREQUENT EXPOSURE TO DIRECT SUNLIGHT OR SIMILAR SOURCES MAY CAUSE THE SURFACE TO DISCOLOUR OR FADE.