

Install Manual

Accessories

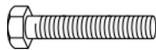

3.5cm flat-head screws*8

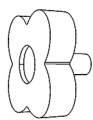

Plum shaped screws*2

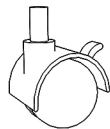

Wheels*4



Top panel board*1

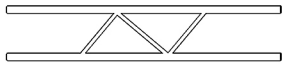

Cross rod*1

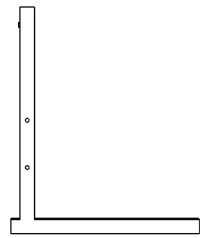

Metal frames*2

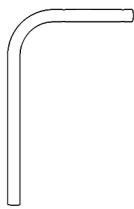

L shaped rods*2

Installation Steps

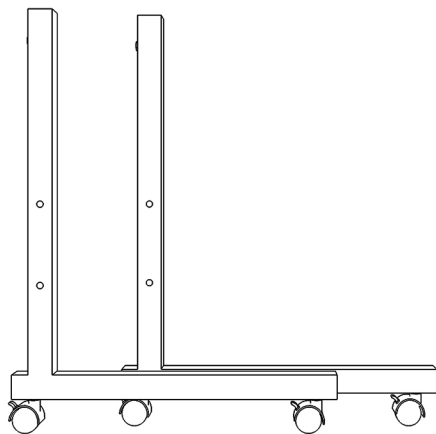

Step 1: Install the 4 wheels with the spanner.

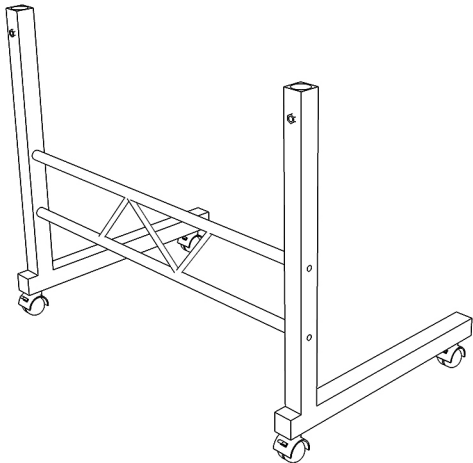

Step 2: Using 4 pcs of 3.5cm flat-head screws to install the cross rod.

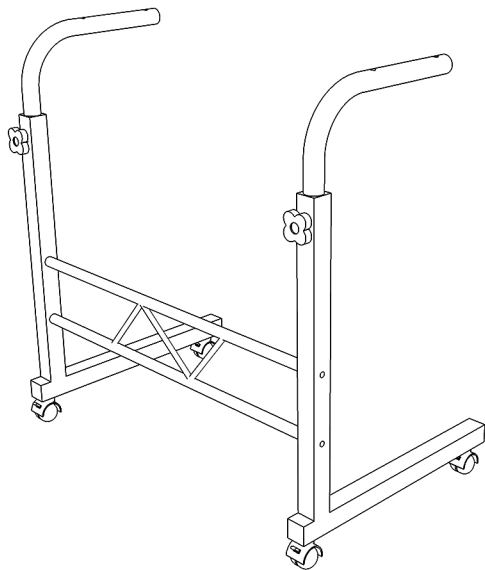

Step 3: Using the plum shaped screws to install the L rods and adjust the height.

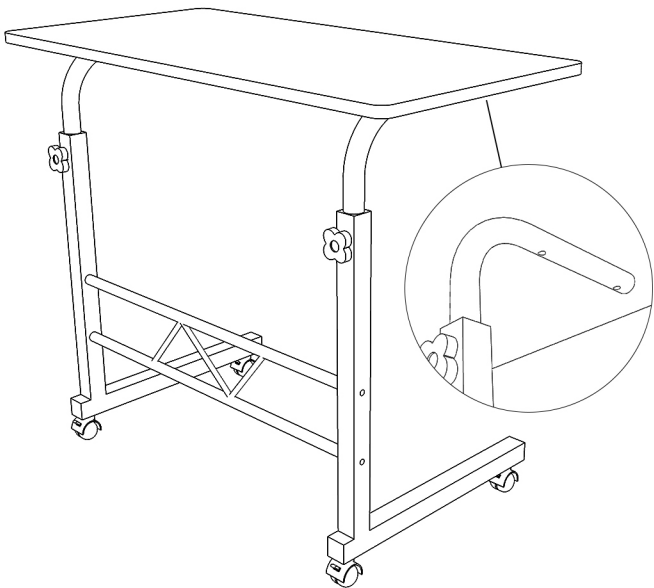

Step 4: Using 4 pcs of 3.5cm flat-head screws to install the panel board .

(Adjust the plum shaped screws when you need to change the height of the desk.)