

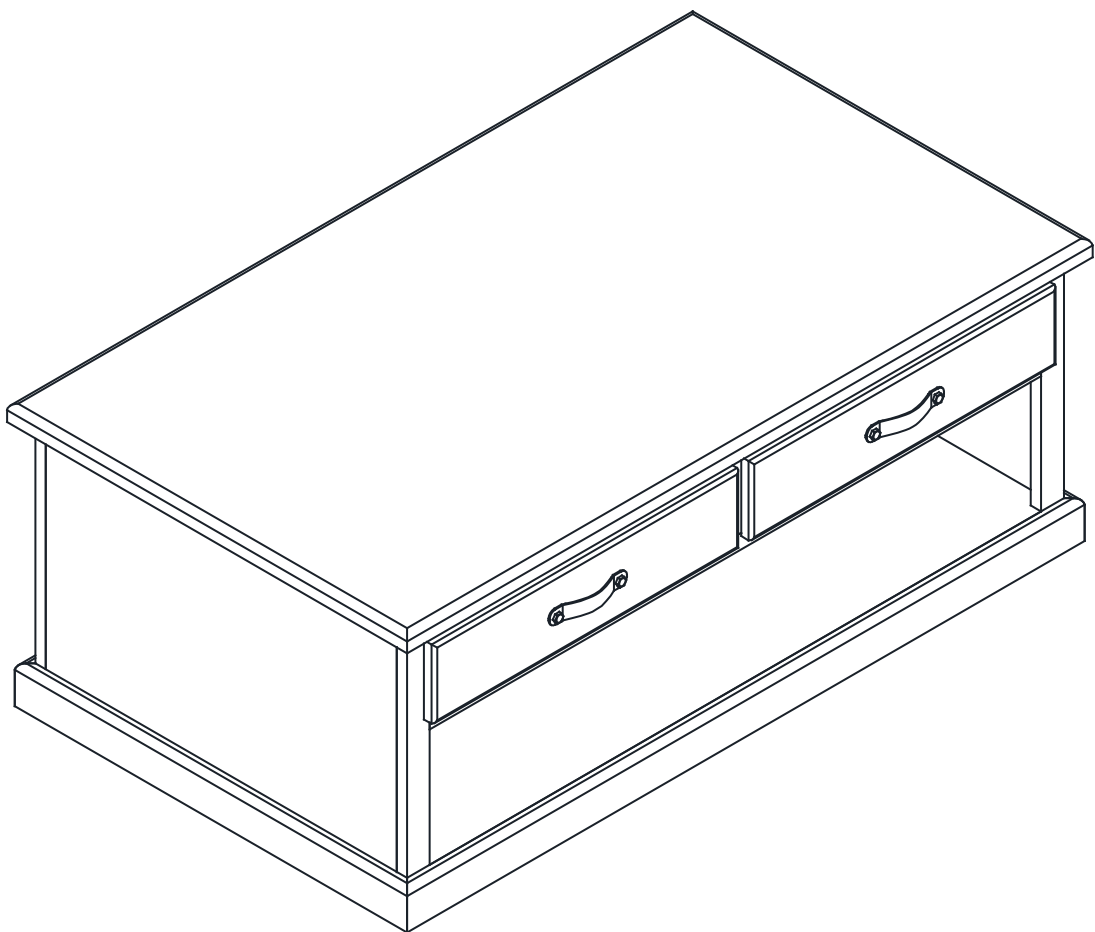

**Fantastic  
Furniture**

Version 1.1



# LONGREACH

Coffee Table 2 Drawer

[fantasticfurniture.com.au](http://fantasticfurniture.com.au)



**WARNING: ENSURE THE WALL STRAP IS ATTACHED TO  
AVOID SERIOUS INJURY.**

To avoid any serious or fatal injury, this product has been fitted with a wall strap to prevent toppling. We strongly recommend that this product is permanently fixed to the wall or other suitable surface. Fixing devices are not included since different surface materials require different attachments. Please seek professional advice if you are in doubt of what fixing device to use.

## **Looks like you've found your Fantastic!**

We're thrilled you've chosen Fantastic Furniture  
to help create a home you'll love!



# **Fantastic Furniture**

### **Love it? Share it!**

Fantastic buy! Share how it looks at home on Instagram for  
your chance to win a \$250 Fantastic Furniture Gift Card!  
**@fantasticfurniture**

# Assembly checklist



Read through the instructions carefully before you begin

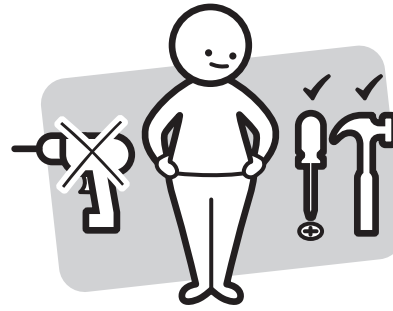

Make sure you have all the required tools.  
Never use power tools unless instructed.

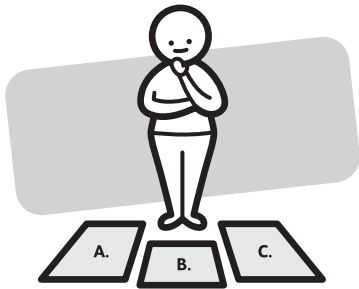

Identify and lay out all of the components before you begin assembly.

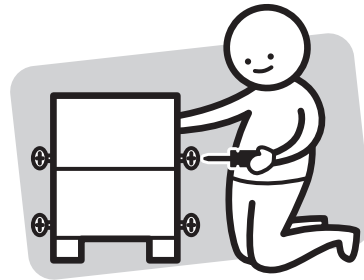

Unless instructed, do not fully tighten screws until the item is fully assembled.

## Useful Information

! Never use power tools unless specifically instructed . They can damage your components or hardware if used incorrectly.

! The most common mistakes made during assembly are using the wrong hardware or getting components back to front.

! Always use a soft surface (such as carpet or cardboard) when assembling your product to avoid scratching or damaging the surface of the product

! Bulky items such as wardrobes and bunk beds should be assembled in the room they will be used in as they may not fit through a door once assembled.

! Never use any glue until you are certain that the parts belong together.

! Periodically check and re-tighten all fasteners. Check the product care label or website for product care instructions.

! If you are having any difficulties assembling your product, missing any hardware or components please visit our website Help Centre for further assistance.

! Please see page 2 for any safety requirements or weight restrictions.

# What you need

To assemble the product



**DO NOT USE**

Other tools you need

## Parts list

Coffee Table

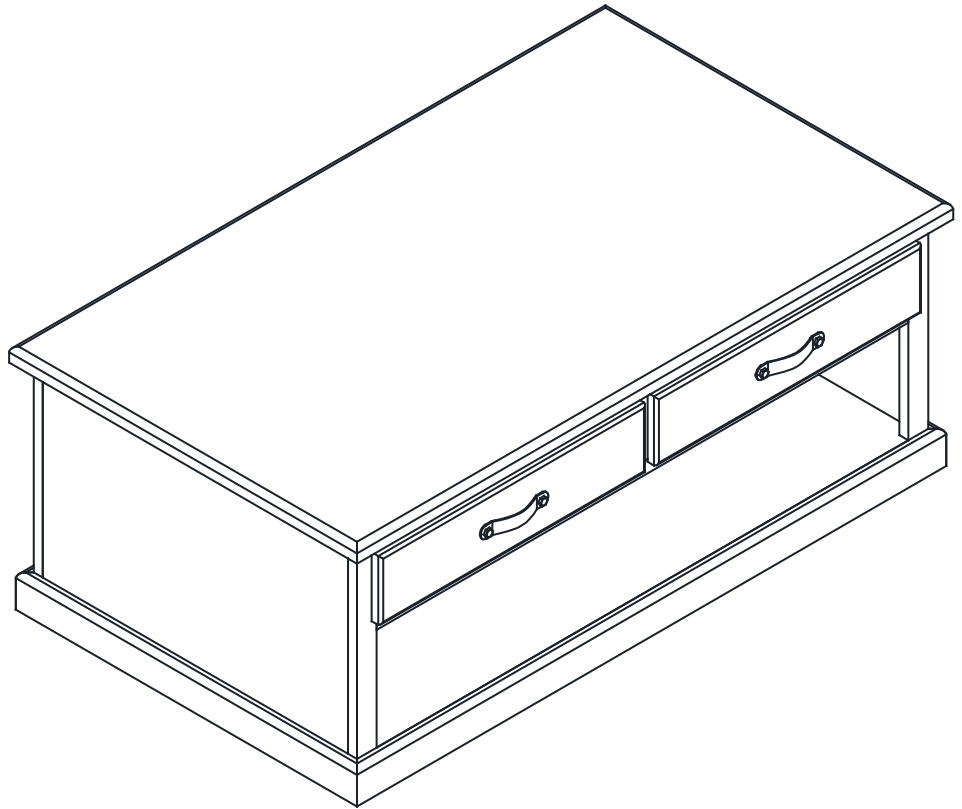

## Hardware Pack

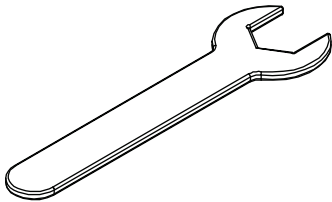

1 x Spanner  
(H1)

**Please make sure you have all these parts before you start.**



**Fantastic  
Furniture**

## Step 1

You will need	
1 x Spanner (H1)	

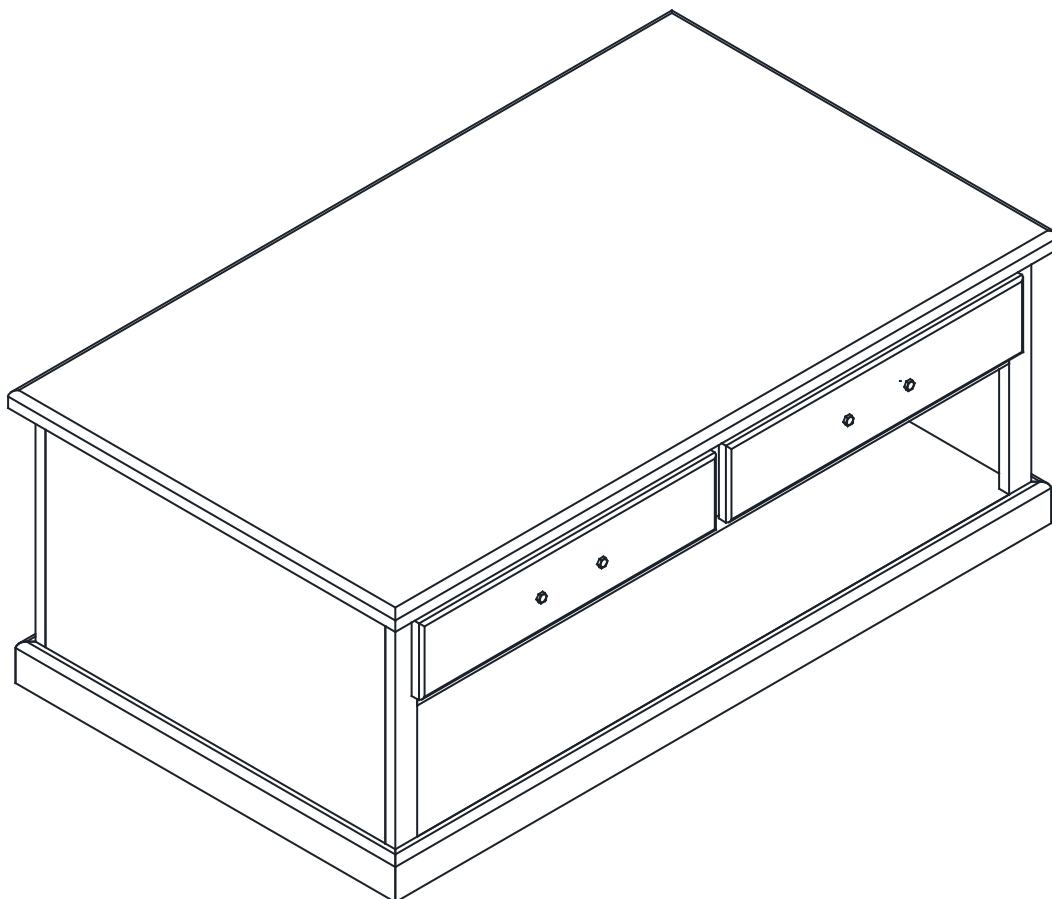
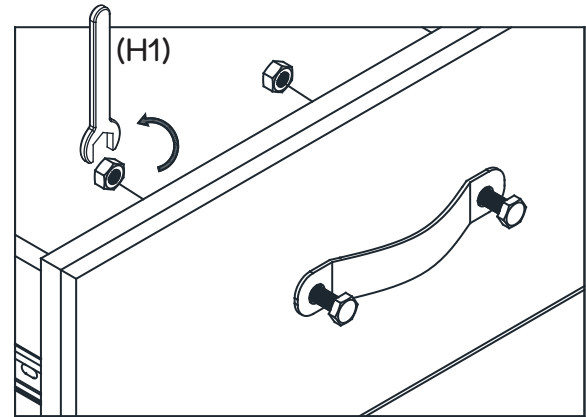
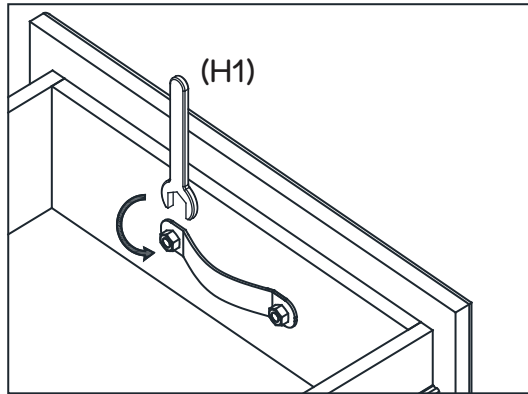

Using a spanner (H1) loosen and remove the handle from the inside of the drawer. Place this handle on the outside of the drawer, tighten both bolts with the spanner (H1). Repeat this step for the second handle.

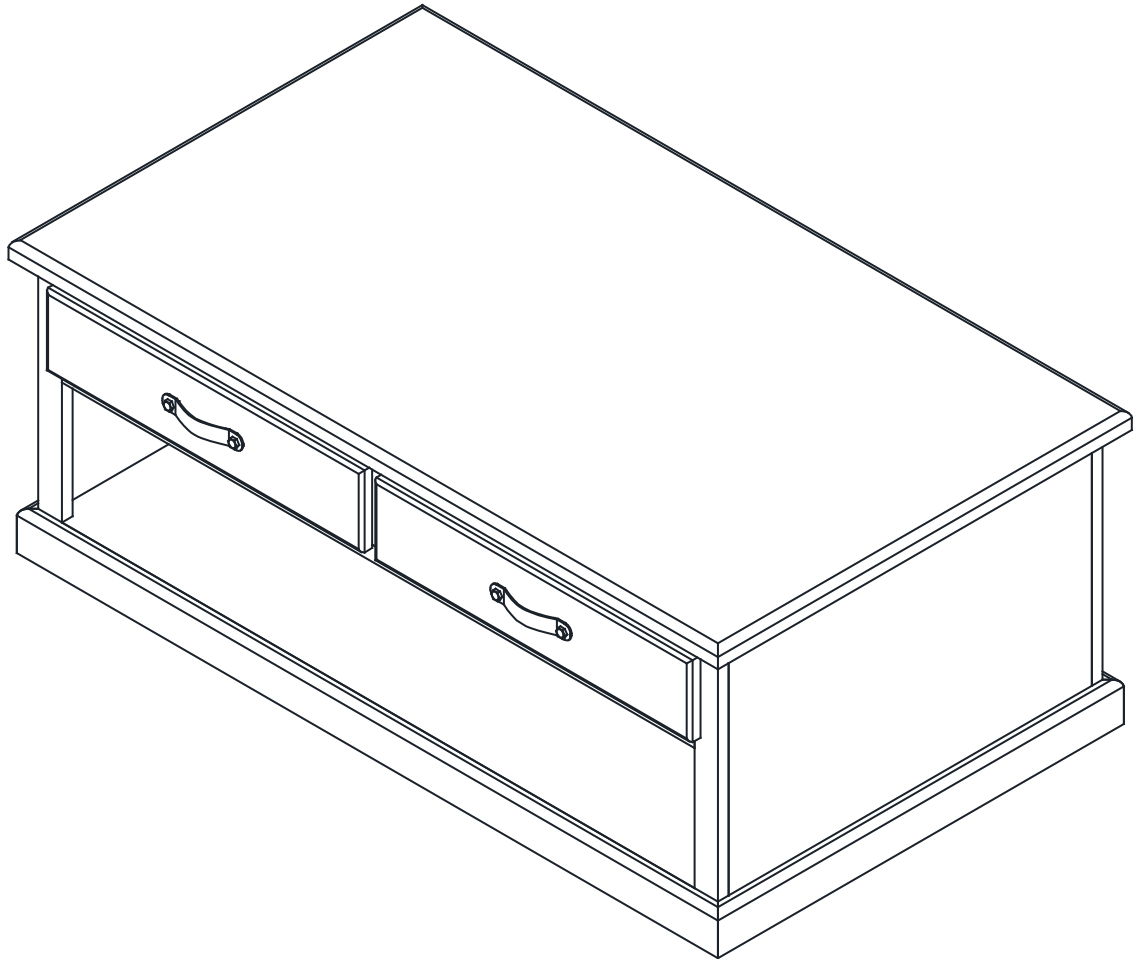

# Job Complete!

In the interest of our environment please dispose of all packaging thoughtfully.